

**Installation advise notes, for Thornhill Range Cookers,**  
**Gas 3 & 5 oven ECO Range Cookers**



The following are notes for the householder and installer to ensure everything is ready for the delivery and installation of your new cooker.

There are 5 areas to check prior to delivery:

- 1: Floor
- 2: Flueing- balanced/room sealed or chimney
- 3: Electrical works
- 4: Fuel, oil or gas plumbing.
- 5 Cupboards and work tops

### **Floors:**

The floor should be at the same level or higher than the rest of the floor.

If the floor is to be tiled, this should be done first, not after the cooker is in place as it is then lower than and impossible to get out/move without damaging tiles.

If the floor is to be wood or other flammable material then the area under the cooker should be tiled or a slab of stone laid, so that it ends up slightly higher than the surrounding floor.

### **Standard Chimney/Flue pipe:**

Any chimney should be lined with a suitable 5"/125mm liner, terminating at a register place. The liner should then have a 'Register plate adaptor' at the bottom ready to take the virtuous enamel flue pipe.

We recommend Flue Supplies, see [fluesupplies.com](http://fluesupplies.com) 5" Register plate adaptor.



This is a picture of a register plate adaptor, the gloss black vitreous enamel flue pipe slip over it. When installed, please email the distance from the plate to the floor as shown, so we know what flue pipe to bring. The centre of the flue should be 120-125mm from the finished back wall.

### **Balanced/Low level discharge/Room sealed, flue installations;**

Please ensure the construction of the wall in the vicinity of the flue outlet is made of non-inflammable materials.

If the walls are hard granite or similar, please inform us straight away.

If your home is constructed of brick skin with timber frame inner walls, then the area around the exhaust must be cleared of flammable materials. This includes standard plaster board which is backed with card board which can catch fire. There are special plasterboards (usually coloured pink) that can be used around the flue.

The size of the area is 200 by 200 (or 200mm diameter) and starts 685mm from the floor.

See diagram below.

Insulation can be replaced with 'calcium silicate board', which we can supply and can take 1,000C.

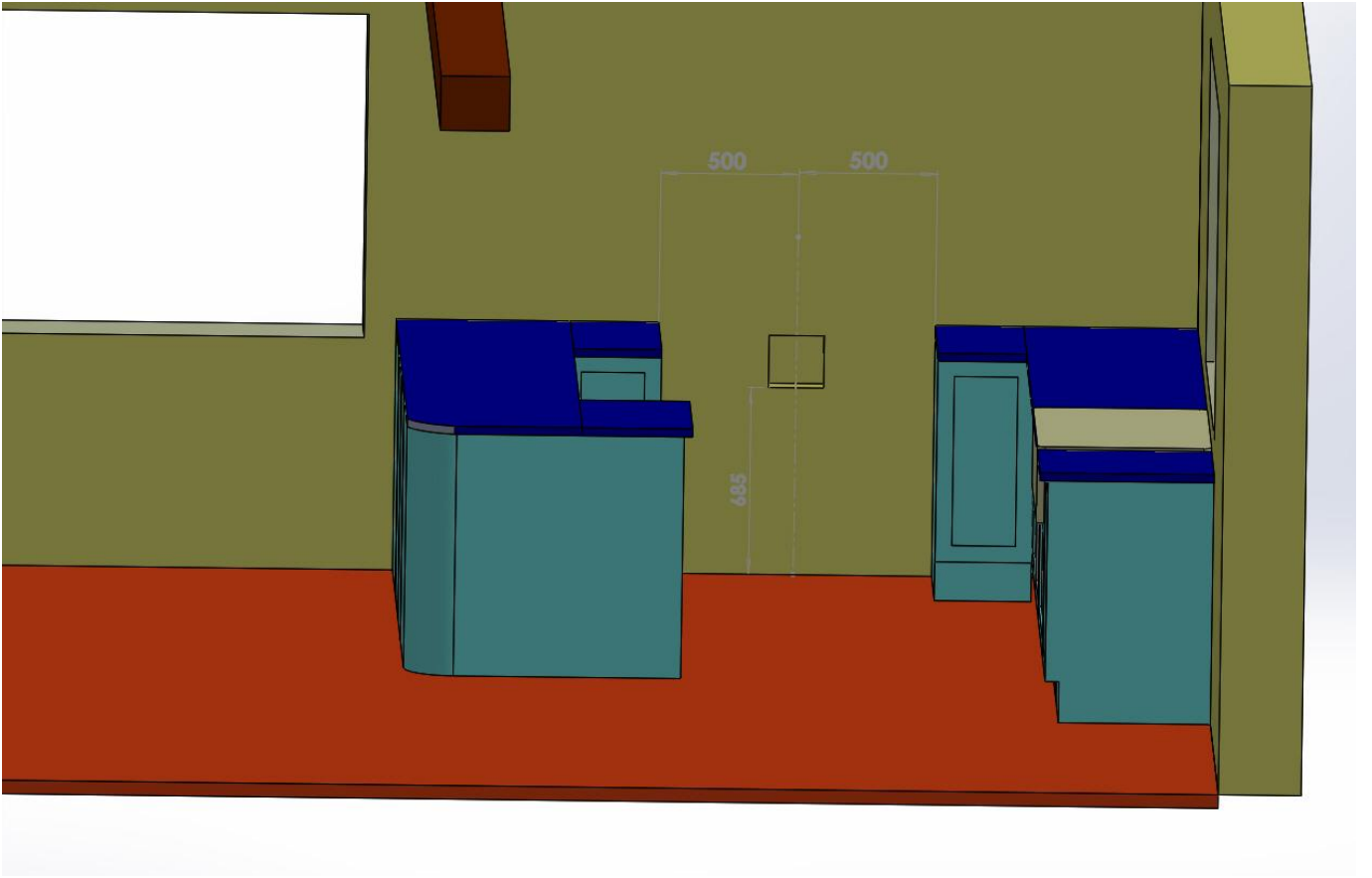

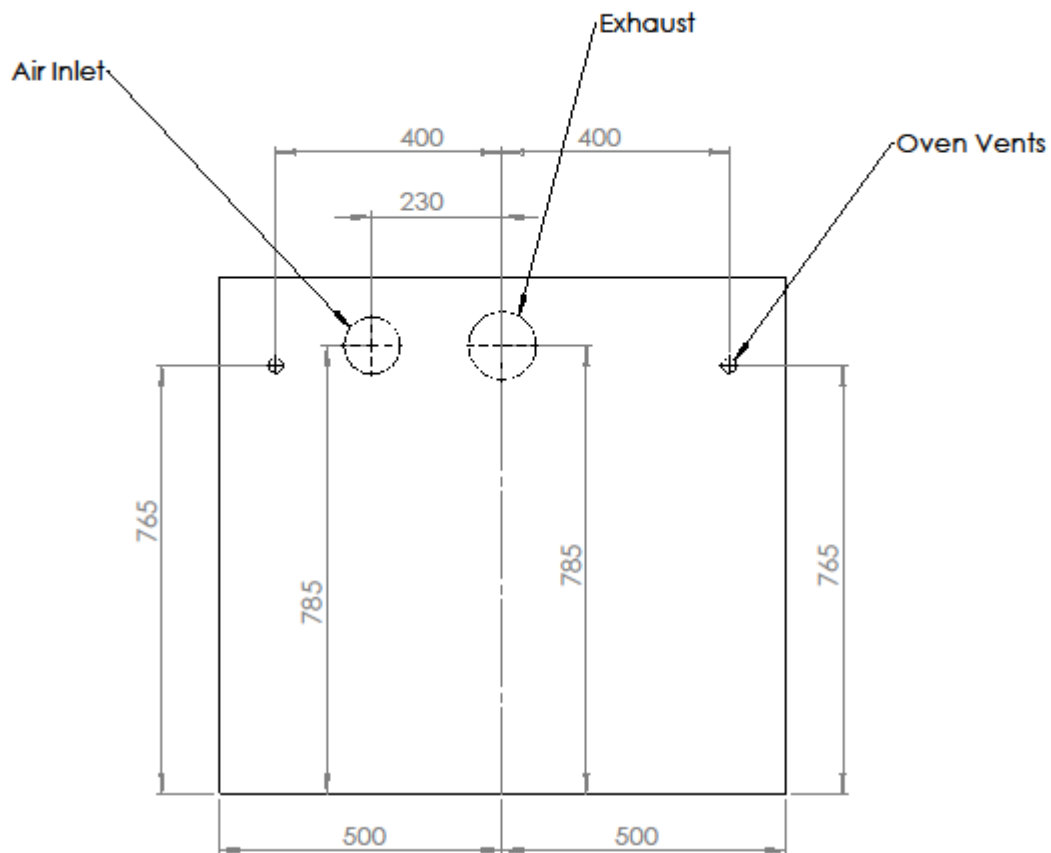

Balanced flue wall holes diagram for 3 or 5 oven oil or gas cooker.  
Looking from inside the room as if looking at the front of the cooker.  
So the air inlet is behind the top left hand oven.

If 5 oven total width is 1,485mm but work from RHS looking at the front.

UNLESS OTHERWISE SPECIFIED: DIMENSIONS ARE IN MILLIMETERS SURFACE FINISH: TOLERANCES: LINEAR: ANGULAR:		FINISH:	DO NOT SCALE DRAWING		REVISION
DRAWN	NAME	DATE			
CHKD	G.Thornhill	04/07/2016			
APPVD					
MFG					
QA			TITLE:		A4
			Balanced flue hole diagram Aug 2015		
			WEIGHT:	SCALE:1:10	SHEET 1 OF 1



Picture shows oven vents, main exhaust vent, air inlet and second oven vent on balanced flue model.

### **Electrical works:**

The fused spur/clock supplied should be wired in place and about 1.5 meters of minimum .75 flex should be left to the left-hand side of the cooker ready to connect inside the cooker.

**If it is a 5 oven cooker** a second flex. connected to a 13-amp fused spur, minimum 2.5mm (immersion heater flex is best), should be left ready by the LH Side of the cooker.

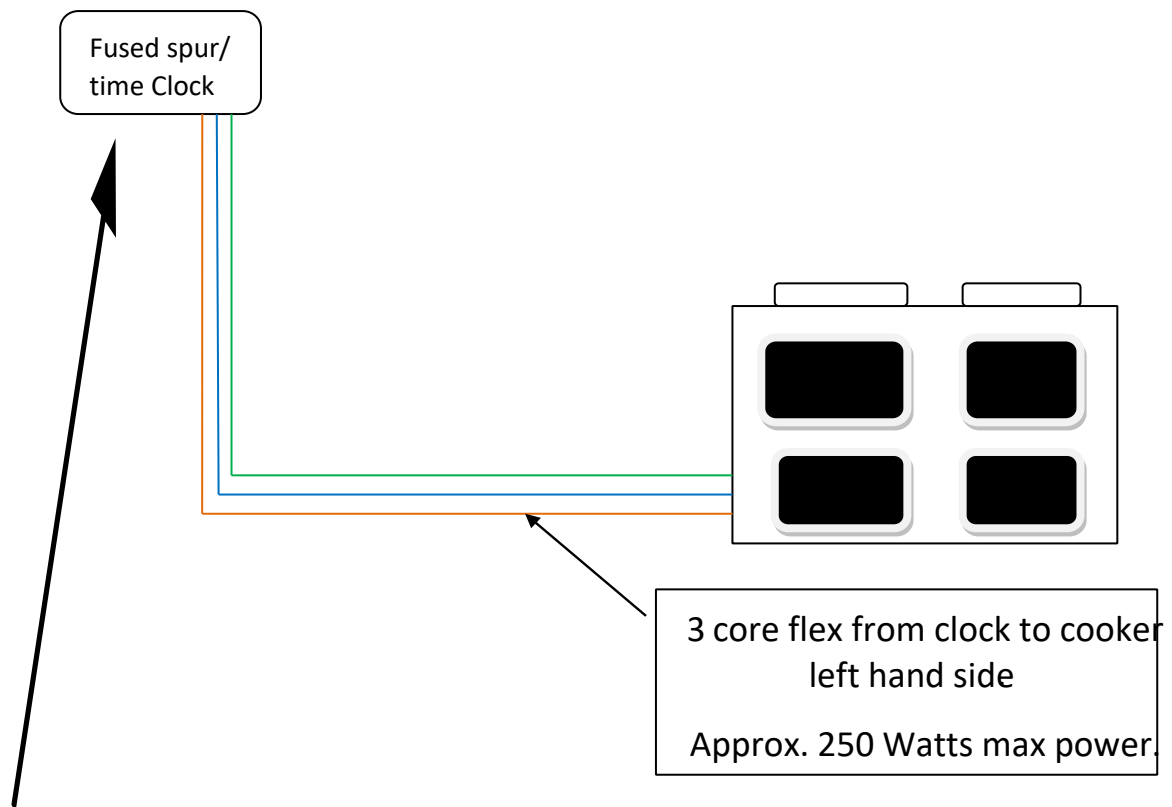

Fused spur/clock with 5-amp fuse. Connect to ring main and leave a flex cable down to the LHS of the cooker.

The clock should be in a convenient position so that:

The clock can be reached easily to set.

You do not have to put your arm over a hot cooker to turn it off.

### **Fuel gas:**

The gas pipe, usually 15mm copper, should be left in the kick space under the left-hand side of the cooker, there should be a gas there which is accessible either from the kick space or through the bottom of the cupboard.

The gas is best about 200-250mm from the left-hand side of the cooker, about 35mm above the floor. The cooker comes with an ½" BSP male fitting on the outside.



Picture show gas fittings, note the electric flexible cables at the back.

### **Cupboards and work tops:**

Cupboards can in theory go right up to and but against the side of the cooker. It is best though to leave a 30-40mm gap to allow air circulation, keeping the both the cupboards and the cooker side cooler.

An infill piece can be added to close the gap in the front.

The work top can then be added leaving a small 3-5mm gap to allow for expansion of the cooker when hot.



Sometime kitchen fitter fit an 'end panel' on the side of the last cupboards to look neat. This is OK provided the area where the kick space is should be cut away to allow air circulation.

Please see the following diagrams.

The same applies to both the left and the right-hand sides.

Best to leave gap between cooker and the cupboards, left and right of 30-40mm minimum.

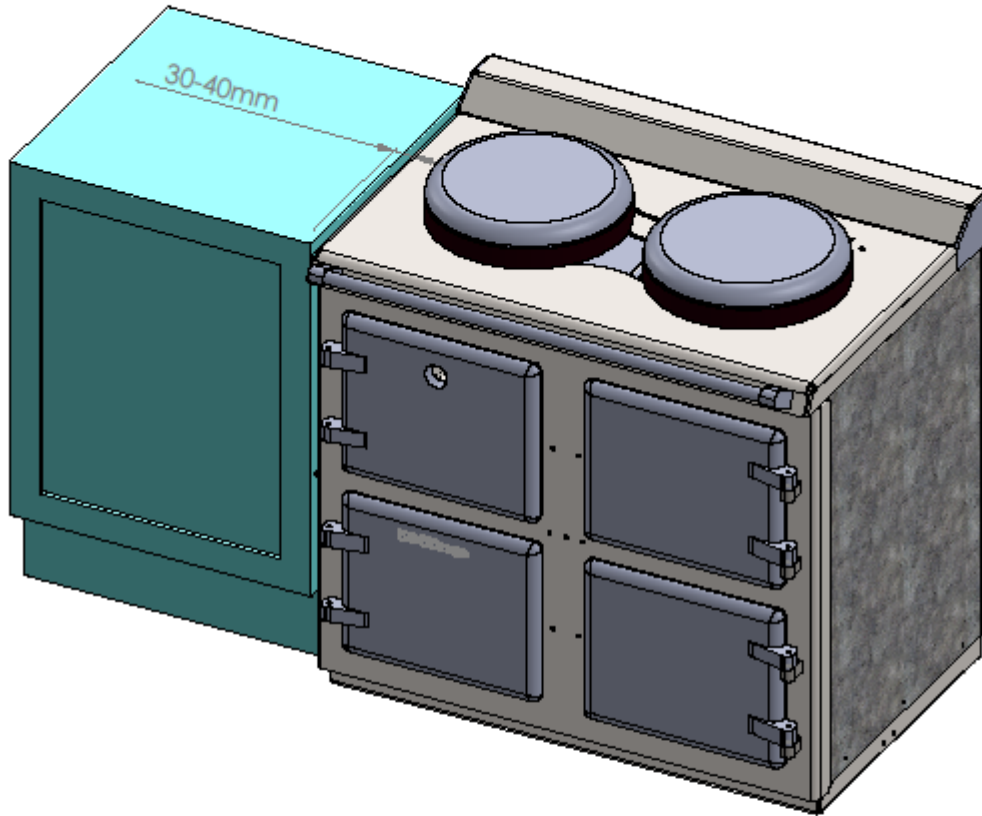

UNLESS OTHERWISE SPECIFIED: DIMENSIONS ARE IN MILLIMETERS SURFACE FINISH: TOLERANCES: LINEAR: ANGULAR:			FINISH:	DEBUR AND BREAK SHARP EDGES	DO NOT SCALE DRAWING	REVISION	
NAME	SIGNATURE	DATE	21/08/2016	<h2>Cooker -cupboard showing air gap</h2>			<b>A4</b>
DRAWN	G.Thornhill						
CHKD							
APPVD							
MFG							
QA				MATERIAL:	TITLE:		
				WEIGHT:	SCALE:1:50	SHEET 1 OF 1	

Infill strip can be added to side of the cupboard to close gap.  
This allows air to circulate.

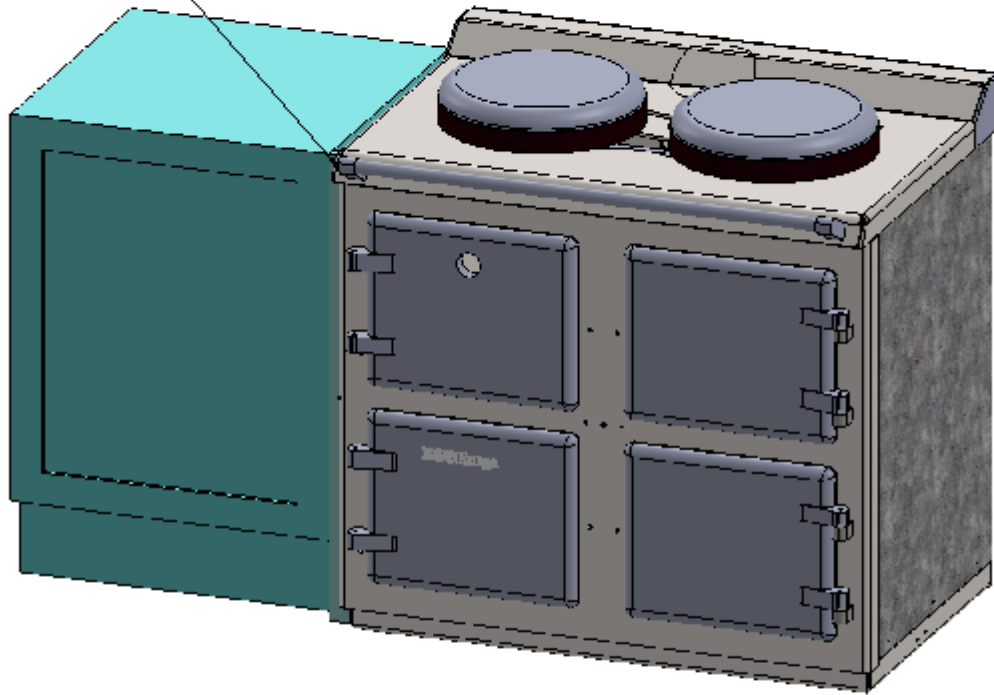

UNLESS OTHERWISE SPECIFIED: DIMENSIONS ARE IN MILLIMETERS SURFACE FINISH: TOLERANCES: LINEAR: ANGULAR:				FINISH:	DEBUR AND BREAK SHARP EDGES	DO NOT SCALE DRAWING	REVISION
	NAME	SIGNATURE	DATE	15/08/2016		TITLE: <b>Cupboard Instalation showing infill strip.</b>	
DRAWN	G.Thomhill						
CHKD							
APPVD							
MFG							
QA					MATERIAL:	DWG NO.	A4
					WEIGHT:	SCALE:1:50	SHEET 1 OF 1

Leave a 3-5mm gap between the work surface and the cooker top to allow for expansion as the top get hotter.

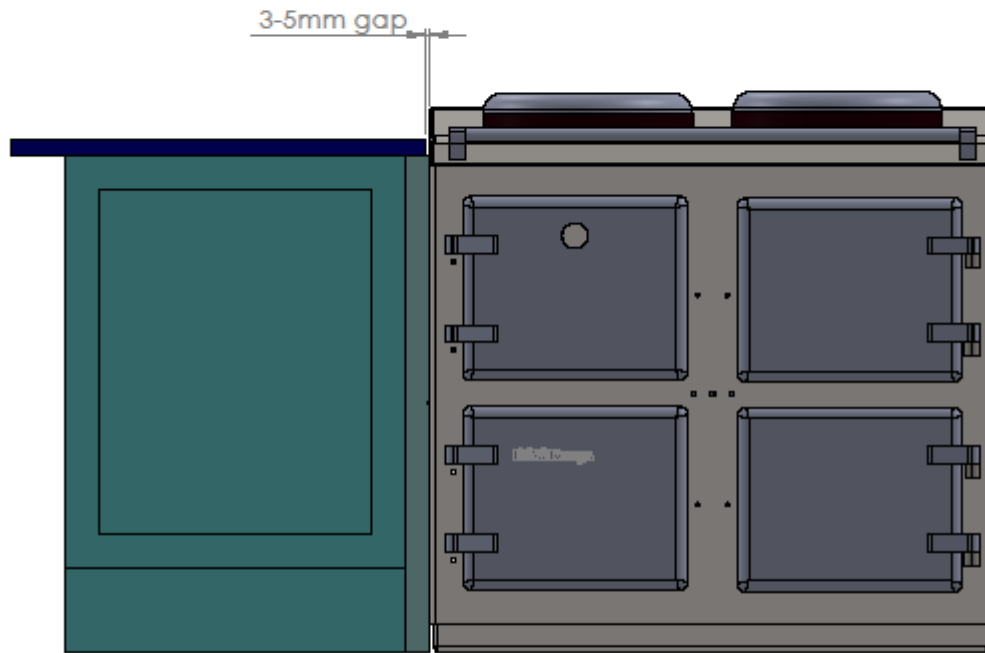

UNLESS OTHERWISE SPECIFIED: DIMENSIONS ARE IN MILLIMETERS				FINISH:		DEBUR AND BREAK SHARP EDGES		DO NOT SCALE DRAWING		REVISION	
SURFACE FINISH:				TOLERANCES:							
LINEAR:				ANGULAR:							
	NAME	SIGNATURE	DATE	18/17/2016				TITLE:			
DRAWN	G.Thornhill							Instalation of work top next to cooker			
CHKD											
APPVD											
MFG											
QA						MATERIAL:		DWG NO.		A4	
						WEIGHT:		SCALE:1:50		SHEET 1 OF 1	

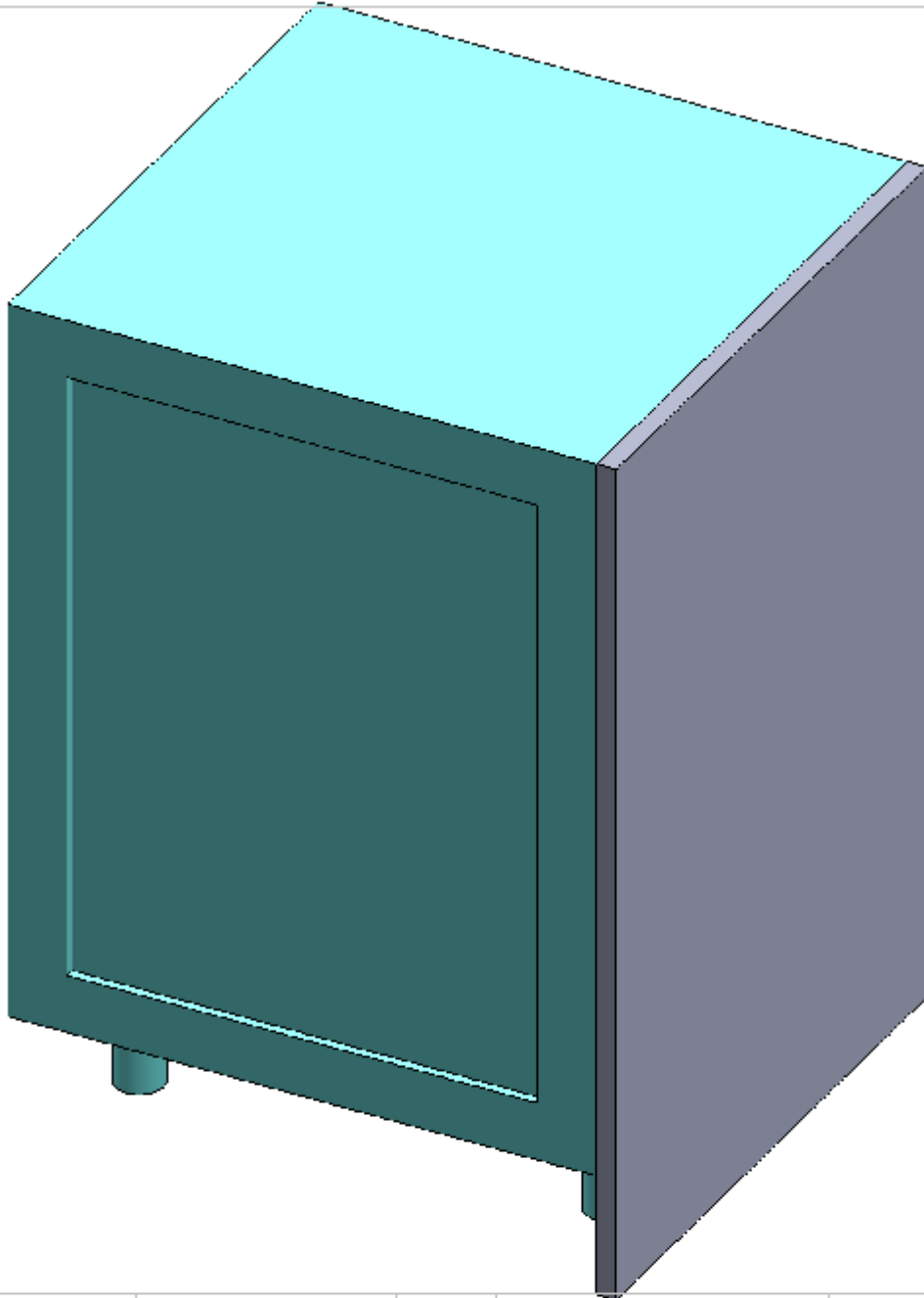

UNLESS OTHERWISE SPECIFIED: DIMENSIONS ARE IN MILLIMETERS		FINISH:		DEBUR AND BREAK SHARP EDGES		DO NOT SCALE DRAWING		REVISION	
SURFACE FINISH:				SCALE 1 : 5					
TOLERANCES:									
LINEAR:									
ANGULAR:									
	NAME	SIGNATURE	DATE	22/07/2016	TITLE:				
DRAWN	G.Thornhill				End cupboards showing side panel. This is blocking air flow.				
CHKD									
APPVD									
MFG									
QA					MATERIAL:	DWG NO.			A4
					WEIGHT:	SCALE:1:30	SHEET 1 OF 1		

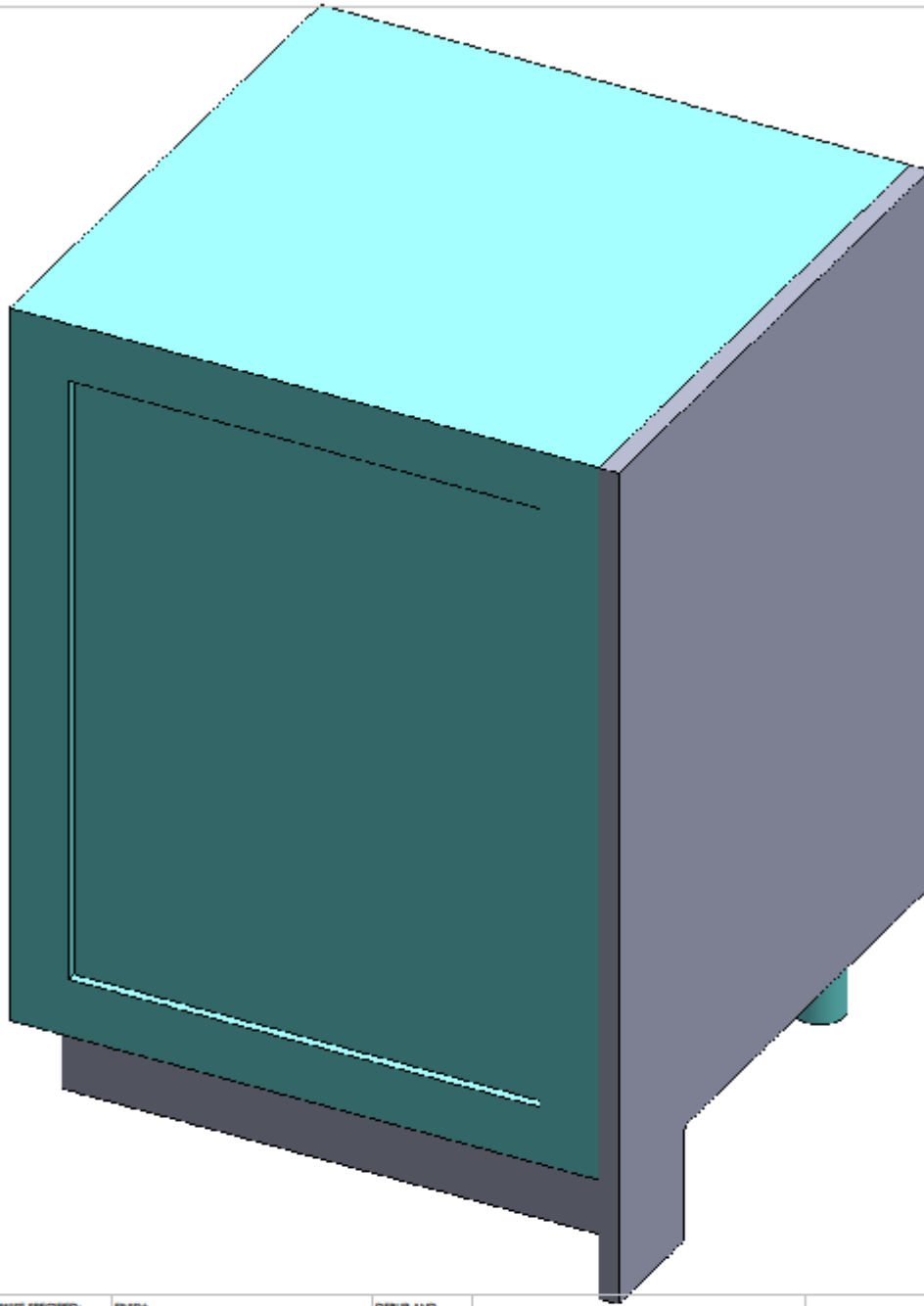

UNLESS OTHERWISE SPECIFIED: DIMENSIONS ARE IN MILLIMETERS			FINISH:		DEBUR AND BREAK SHARP EDGES		DO NOT SCALE DRAWING		REVISION	
SURFACE FINISH:					SCALE 1 : 5					
TOLERANCES:										
LINEAR:										
ANGULAR:										
	NAME	SIGNATURE	DATE	22/05/2016	TITLE:					
DRAWN	G.Thomhill				End cupboards showing side pannel cut away, to allow air flow					
CHKD										
APPVD										
MFG										
QA					MATERIAL:		DWG NO.			A4
					WEIGHT:		SCALE:1:30		SHEET 1 OF 1	



A neat installation, show the front fill piece has been blended in and the work top fitted with about 3mm gap.